



ProScanner Setup Guide

This guide will walk you through the steps to get your Fit3D ProScanner up and running.



QUESTIONS?

Visit our online help center at support.fit3d.com

1 Select a Location for the ProScanner

For the best scan quality, please ensure the environment for ProScanner is appropriate. The three most important factors are:

- Adequate spacing;
- No reflective surfaces;
- No natural sunlight.

Please see notes below for more info.

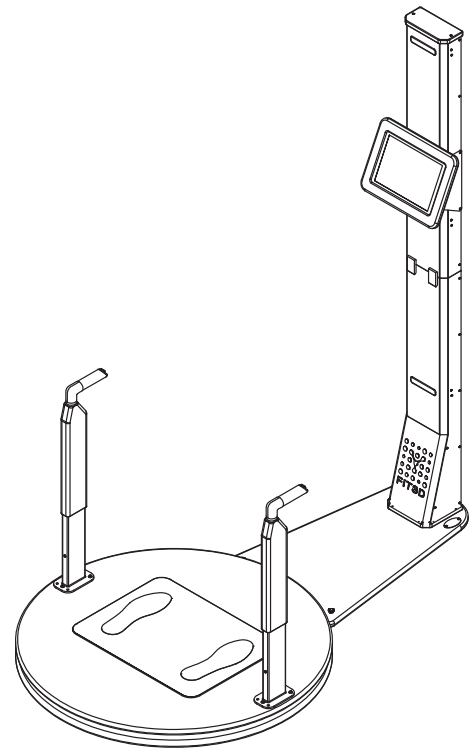

No reflective surfaces in view of the cameras

Mirrors, glossy posters, windows, and chrome finishes can cause poor quality scans and failures.



No natural sunlight in view of the cameras

Natural sunlight can cause poor quality scans and failures.

Adequate space is CRITICAL for scan processing and accurate data. A clear area 62 x 78 in (157 x 198 cm) is required.

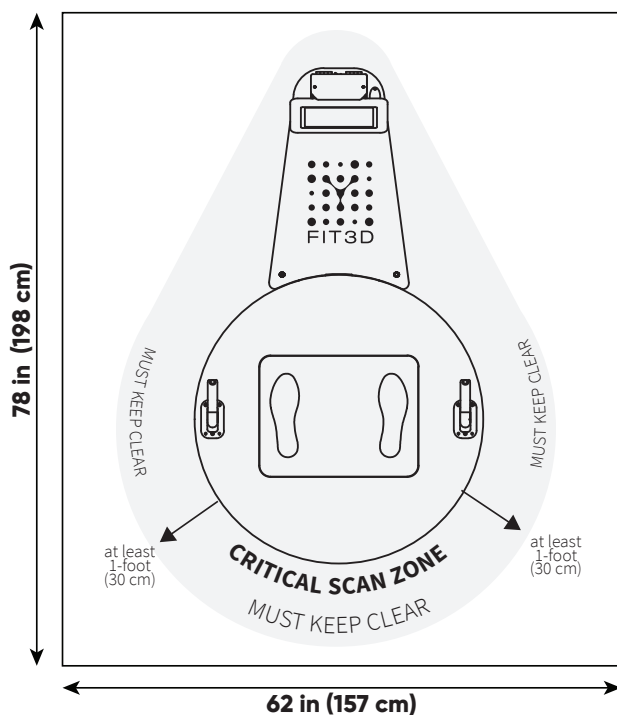

Spacing Advisory for ProScanner System

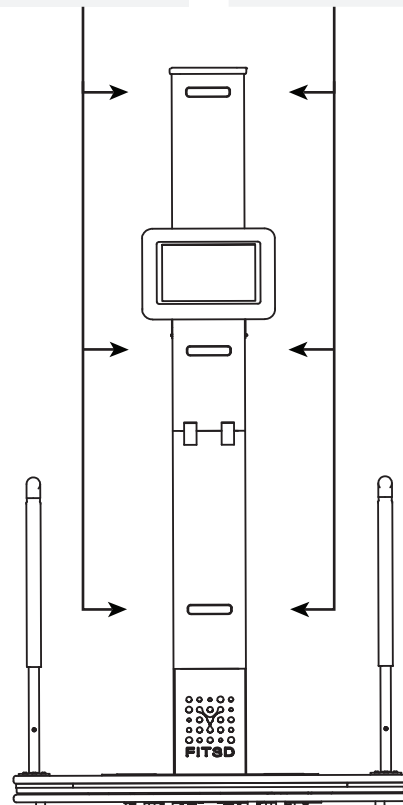

2 Prepare the Camera Tower Assembly

1 Unfold camera tower to stand upright

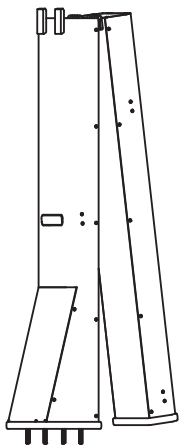

2 Hook and push both latches down to secure

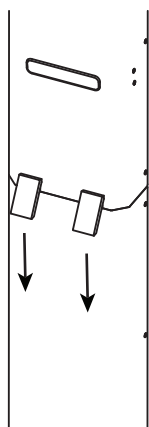

3 Carefully insert the camera tower into the base

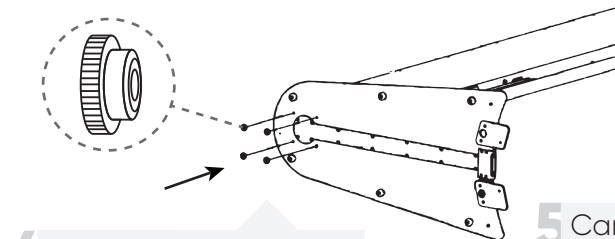
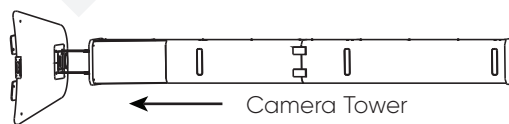

4 Attach 4 thumb nuts to secure camera tower

5 Carefully Raise the Tower

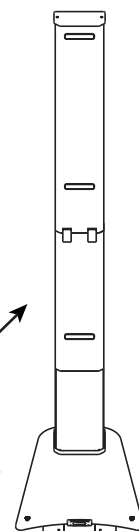

3 Attach the Camera Tower to the Turntable

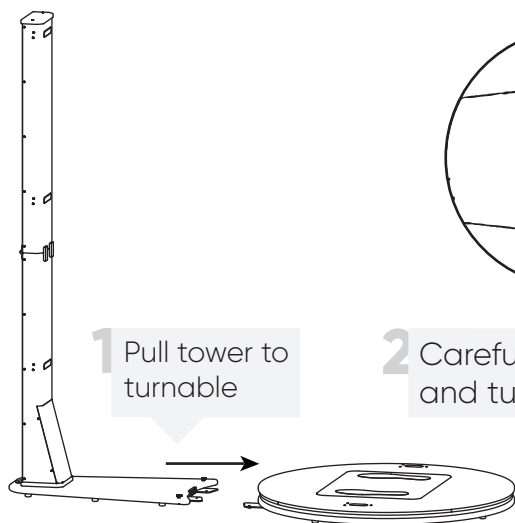

1 Pull tower to turntable

2 Carefully align base and turntable

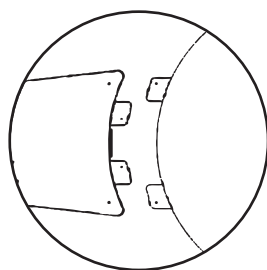

3 Ensure connection is fully engaged

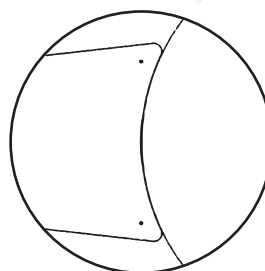

4 Attach 2 nylon thumb screws to secure

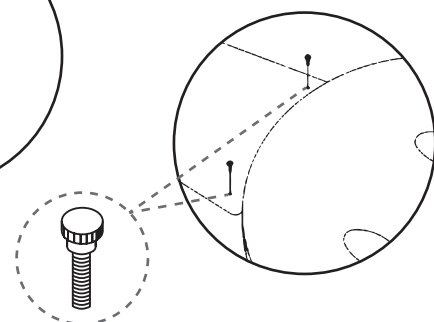

4 Install the Handles

1 Connect handles and turntable

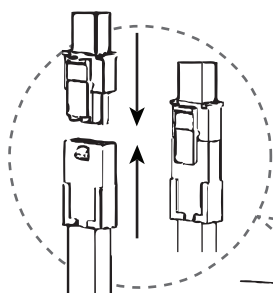

2 After connection, set handles upright

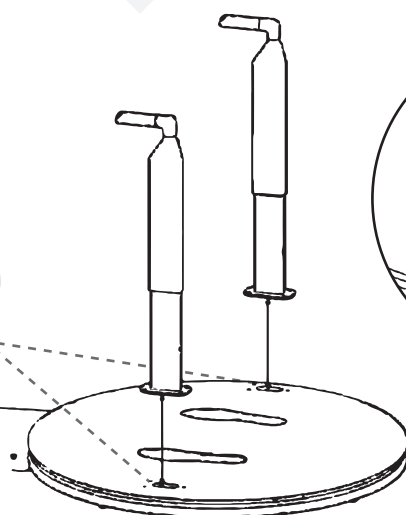

3 Use 3 metal screws to secure each handle

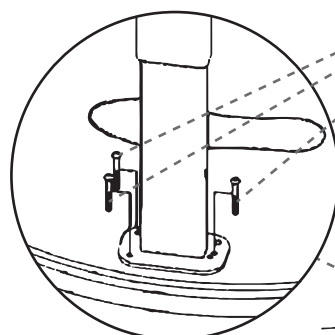

4 Use Allen key (included) to tighten screws

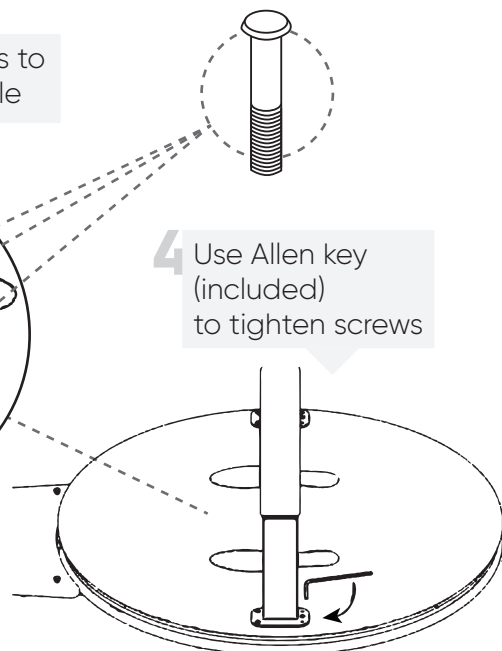

5 Prepare the Camera Tower Assembly

- 1 Connect the USB Type-C and Type-A angle adapters as shown

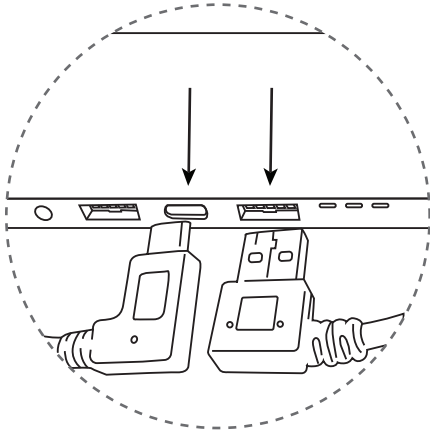

- 2 Set the tablet into the bezel

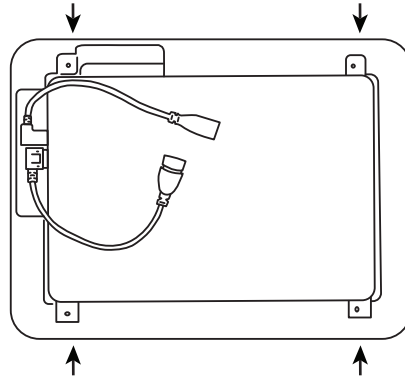

- 3 Attach the left and right mounting brackets to the bezel with four of the included screws

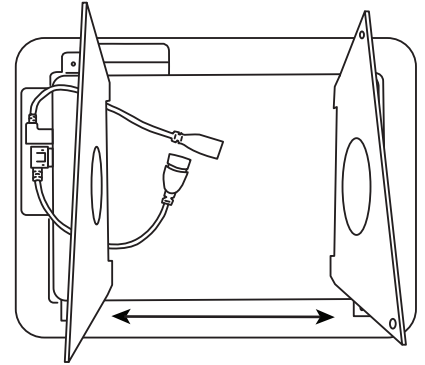

- 4 Route the cables underneath the mounting bracket as shown

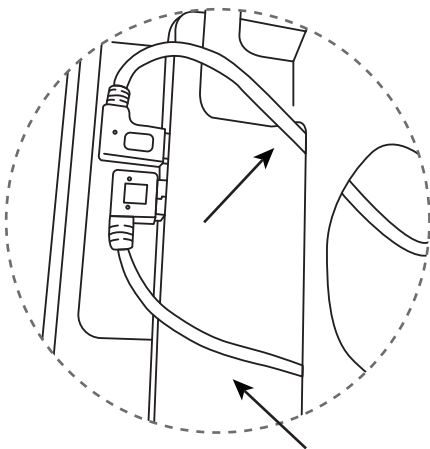

- 5 Connect the tablet power supply and the USB cable to the adapters. Route the cables through the round hole of the mounting bracket on the right as shown

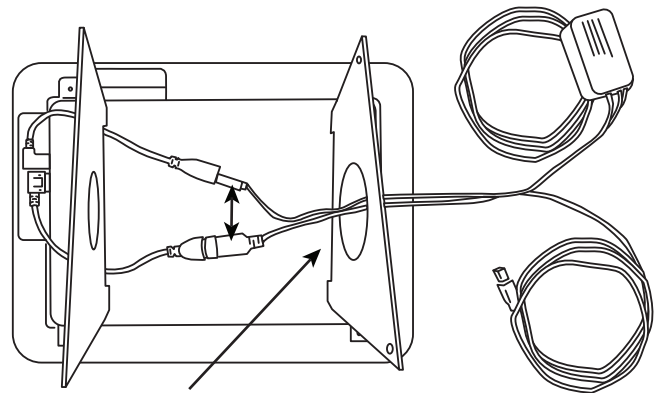

- 6 Remove the four small screws from the camera tower located along the rear edge above the center camera location. Use four of the longer screws included with the tablet accessories to attach the tablet assembly to the camera tower

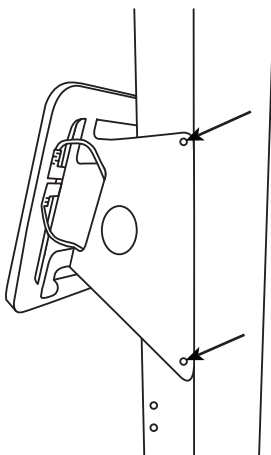

**Attach
Screws**

**Center
Camera
View**

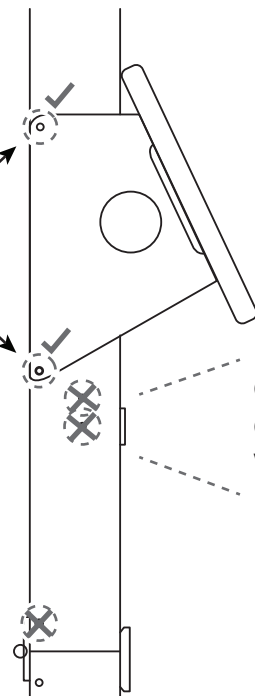

- 7 Route the tablet USB and power cables using cable clips

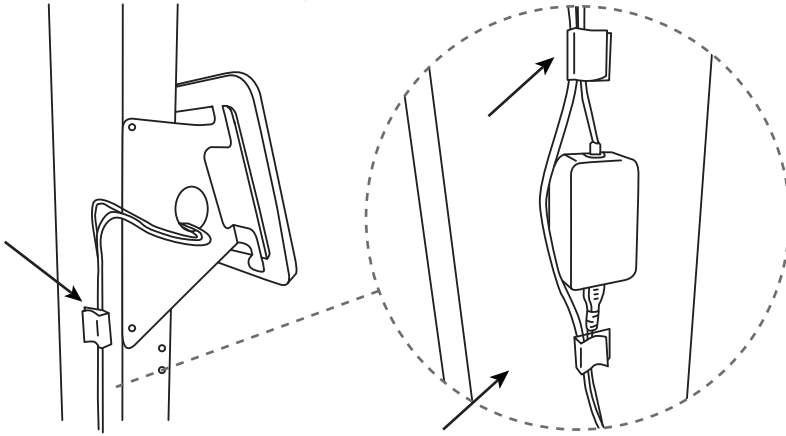

- 8 Connect the USB cable to the camera tower

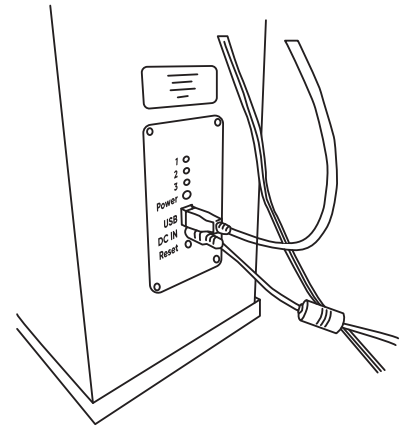

6 System Power and Calibration

Connect the ProScanner power supply to the camera tower control module

Connect the ProScanner and tablet power supplies to a power outlet

All of the lights on the camera tower will illuminate and the turntable will begin to rotate

When you power the ProScanner on for the first time, the turntable will spin around once and stop facing the camera tower. On the back panel, you should only see the blue light for power when calibration is complete

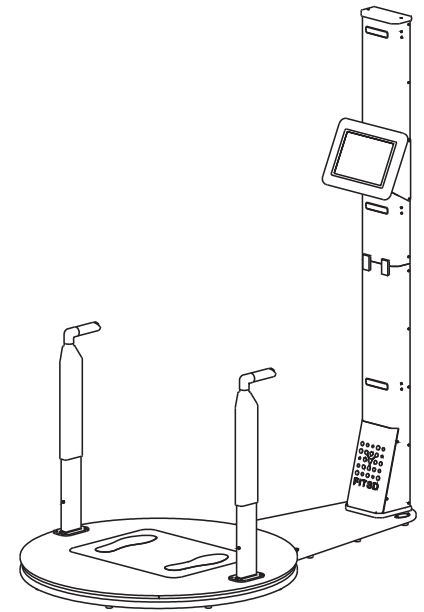

7 Starting the Tablet And Application

Turn on the tablet by holding the power button for 5 full seconds

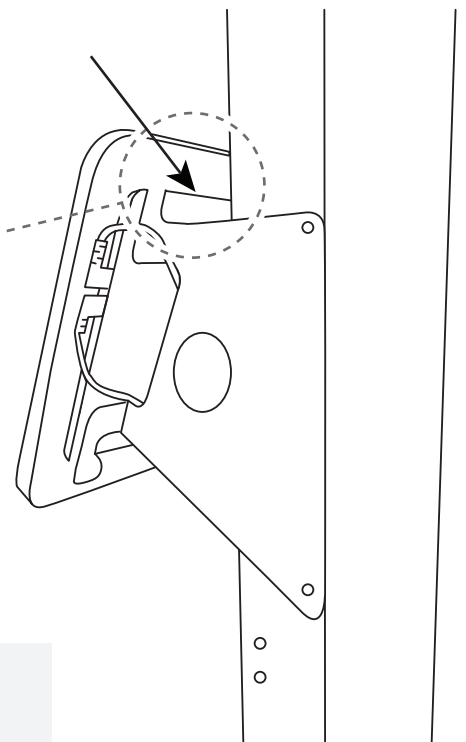
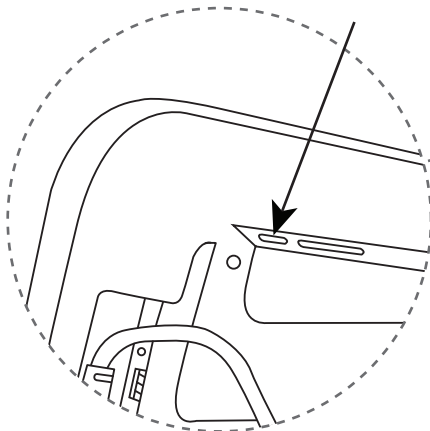

- Connect to a Wi-Fi network.
- Double-tap the ProScanner application icon to start the program.
- Follow the on-screen instructions to complete system activation.